

PRESCRIBED COMPOSITE/MAP No. 271

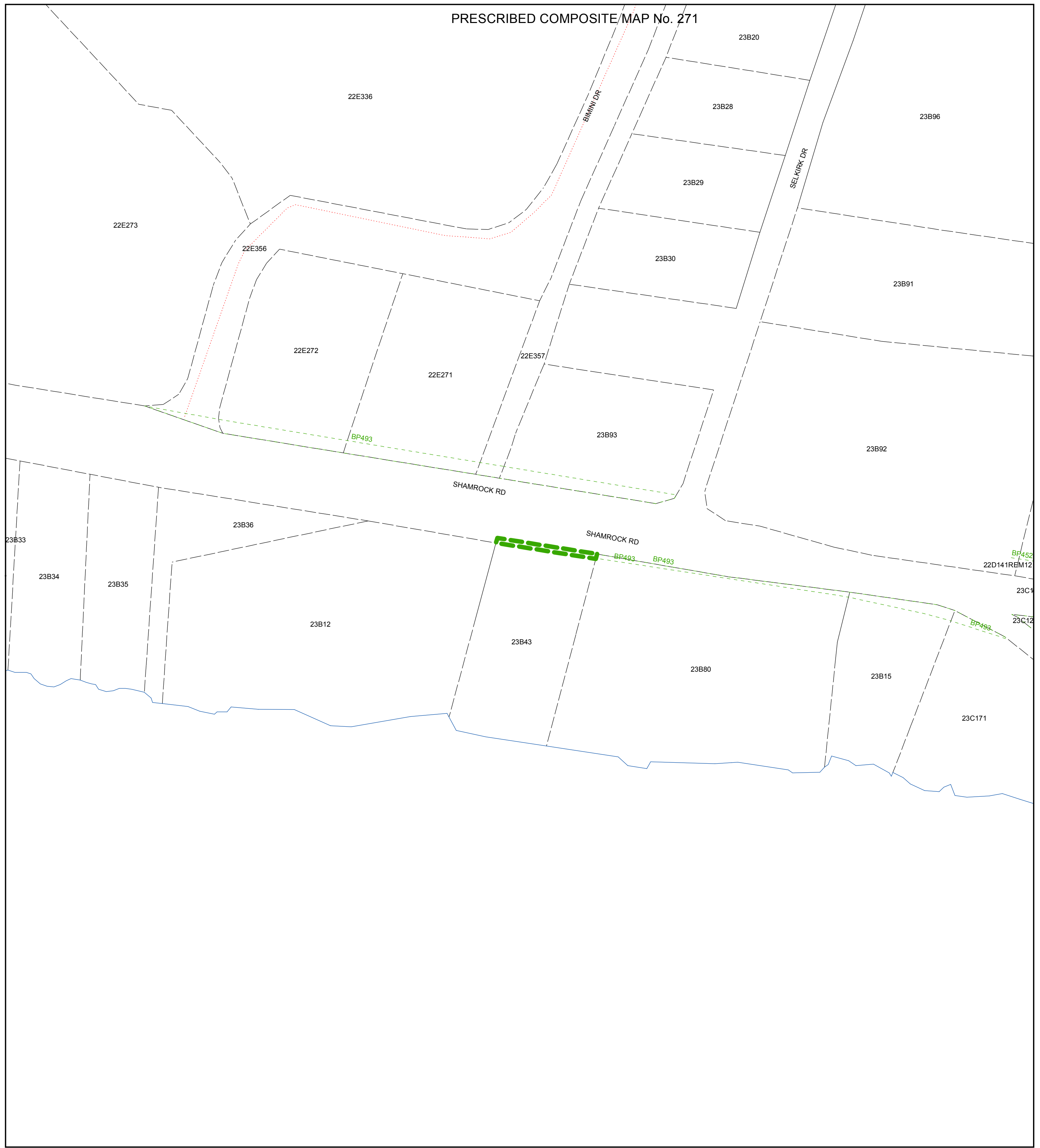

Prepared by : Date :	J. Dixon 16 March 2011
GIS checked by : Date :	
Quality Control by : Date :	
Chief Surveyor : Date Approved :	R. Vasquez 6/04/11
L&S Job No. : Forms: PCM_Small	26864

TITLE	ROAD DEFINITION OF SHAMROCK RD, OPPOSITE SELKIRK DR, PROSPECT	
	LEGEND / ABBREVIATIONS / AMENDMENTS	
SCALE		
	Definition Road Widening	

	PRESCRIBED COMPOSITE MAP No.	PCM271
	BLOCK No.	23B
LANDS AND SURVEY DEPARTMENT CAYMAN ISLANDS GOVERNMENT P.O. Box 1089 Grand Cayman KY1-1102 CAYMAN ISLANDS		
Base Plan: 03/444 Gazette 13/2011, Monday 20 June 2011		