

PRESCRIBED COMPOSITE MAP No. 272

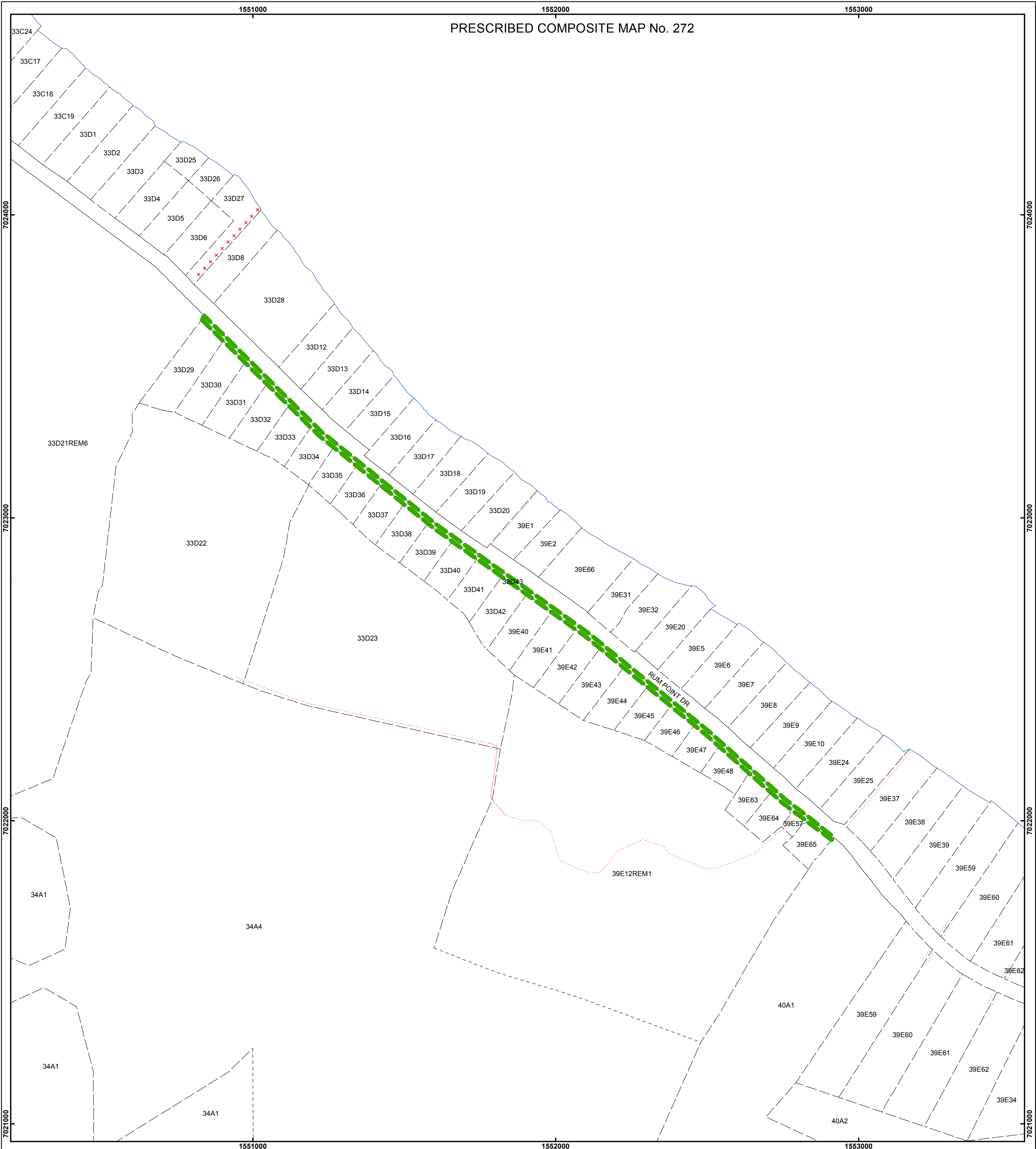

Prepared by : Date :	J. Dixon 17 March 2011
GIS checked by : Date :	
Quality Control by : Date :	
Chief Surveyor : Date Approved :	R. Vasquez 4/04/11
L&S Job No. : Forms: PCM_Small	26867

TITLE	ROAD WIDENING ALONG RUM POINT DRIVE, NORTH SIDE	
	SCALE	
		Feet
LEGEND / ABBREVIATIONS / AMENDMENTS		
Road definition		Base Plan: 50/633 Gazette 13/2011, Monday 20 June 2011

PRESCRIBED COMPOSITE MAP No.	PCM272
BLOCK No.	33D
LANDS AND SURVEY DEPARTMENT CAYMAN ISLANDS GOVERNMENT P.O. Box 1089 Grand Cayman KY1-1102 CAYMAN ISLANDS	